

2-Wire Video Outdoor Station

User Manual

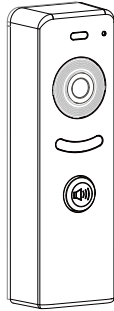

DT-ENG-616-V1 202208

2. Mounting

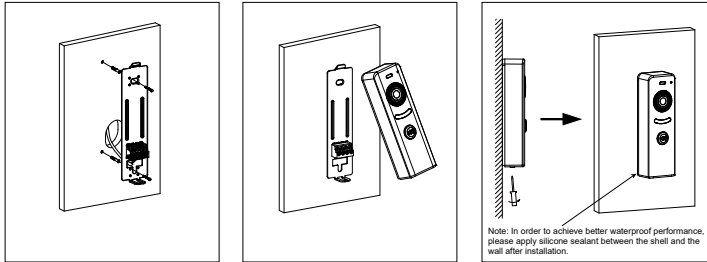

1. Installation height for door station usually is 145~160cm.
2. Use screws to fix the back panel to the wall after connect the cable correctly.
3. Attach the front panel to the back panel, then use the screw to fix it.

1. Parts and Functions

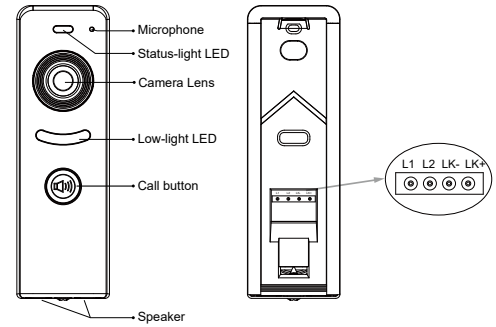

L1,L2: Connect to the bus line, no polarity.

LK+,LK-: Connect to the lock, output +12Vdc when working.

3. System Wiring and Connections

The maximum distance of the wiring is limited in the DT system. Using different cables may also affect the maximum distance which the system can reach.

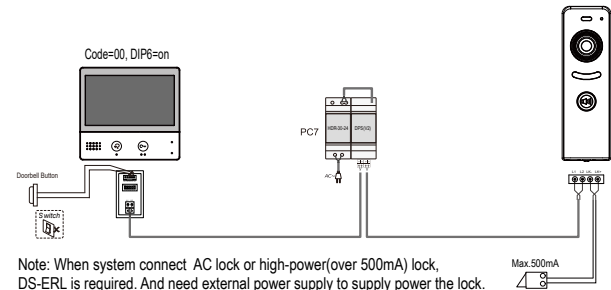

Note: Setup the Unlock Mode Parameter for different lock types.
Power-on-to-unlock type:Unlock Mode=Power off_Unlock(by default)
Power-off-to-unlock type:Unlock Mode=Power on_Unlock

4.Unlock Time Setting

Step1. Enter the setup state

Within 10 seconds after power-on, press and hold the Call key until the "BP" sound is heard for 3 times and then release it (the "BP" sound will be heard once per second) to enter the unlocking time setting state, and the indicator light will flash slowly;

Step2. Set the unlock time

Press and hold the Call key for a long time to set the unlocking time.

The time of pressing and holding is equal to the unlocking time.

The time of 01-99s can be set. The default is 1s;

In the setting process, the time will be prompted by the "BP" sound, and each sound is 1s;

Step3. Save & Exit

After setting, automatically save and exit within 10s without operation;

or the outdoor unit will automatically save and exit when the power is off;

6.Address settings of Door station

Step1. Enter the setup state

Within 10 seconds after power-on, press and hold the Call key until the "BP" sound is heard for 9 times and then release it (the "BP" sound will be heard once per second) to enter the DS address setting state, and the indicator light will flash " off,on / off,on/ off,on", there is an interval of 1s, and repeat flush.

Step2. Set the unlock time

Press the Call key to set the DS address, and switch one address each time; The address will be prompted by the "BP" sound in the setting process;

Step3. Save & Exit

After setting, automatically save and exit within 10s without operation;

or the outdoor unit will automatically save and exit when the power is off;

5.Unlock Mode Setting

Step1. Enter the setup state

Within 10 seconds after power-on, press and hold the Call key until the "BP" sound is heard for 6 times and then release it (the "BP" sound will be heard once per second) to enter the unlocking mode setting state, and the indicator light will flash quickly;

Step2. Set the unlock mode

Press the Call key to switch the unlocking mode back and forth;

The NC/NO mode will be prompted by the "BP" sound during the setting process,

BP + long tone, representing NO, two tones of BP, representing NC.

The default is NO mode.

Note:The unlocking mode can also be set remotely through the monitor code.

Step3. Save & Exit

After setting, automatically save and exit within 10s without operation;

or the outdoor unit will automatically save and exit when the power is off;

7.How to initialize

Step1. Enter the setup state

Press and hold the key first, and then power on. After power on, keep the key pressed until the "BP" sound is heard for 3 times and then release it (the "BP" sound will be heard once per second) to enter the setting state, and the indicator light will flash slowly;

Step2. Initialization

Press the Call key once to execute the factory initialization operation, and complete and exit after a long sound of "BP +";

8. Specifications

- Power Supply : DC 24-28V ;
- Power Consumption: Standby 7mA; Working status 83mA;
- Camera: Color CMOS, 2.0 Mega pixel, 1/3" fisheye camera, 165° wide angle;
- Lock Power supply: 12Vdc, 500mA(Internal Power);
- Mounting: Surface mounting
- Working temperature: -15°C ~ +55°C
- Dimension: 136(H)×43(W)×28.8(D)mm